

**EAA MODEL: BUNDA SEMI AUTO SHOTGUN
WARNING AND INSTRUCTION MANUAL
PLEASE READ THESE INSTRUCTIONS**

MODEL NUMBER	BARREL LENGTH	CALIBERS	FINISH	TYPE
BUNDA	19", 24", 26", 28", 30"	12GA	BLUE	S/A SHOTGUN

GENERAL INFORMATION :
Weight (average) - 28" = 9.5 LBS
Overall Length - 41" TO 52"

FOR YOUR SAFETY AND THE SAFETY OF OTHERS, this owner's manual contains important warnings and safety procedures which must be understood BEFORE using this firearm. Read the entire manual and if you do not understand any part of it or the operation of your shotgun, stop and seek professional firearms instructions. You can get a copy of this manual from European American Armory Corp. on request.

Record the serial number of your firearm # :
and a description of it :

Make a copy of this manual, proof of purchase/sales record for safekeeping in a secure safe or fireproof container. Such proof is necessary if the firearm is stolen or for warranty repair. Before handling any firearm, make sure you know the safety procedures and most importantly, keep the firearm pointed in a safe direction.

WARNING

****YOU RISK INJURY OR DEATH BY HANDLING THIS FIREARM****

Before handling this firearm, read, understand and follow the instructions in this. Always keep this manual with the firearm. If you lend, give or sell this firearm, be sure the manual goes with it. If there is anything you do not understand, seek advice from someone qualified in safe handling of firearms. This firearm should always be transported unloaded in its case.

TYPE OF AMMUNITION TO BE USED

It is suggested that high quality commercially manufactured ammunition be used in this firearm. Some factory ammunition works better than others and you should stick with the brand you find works well in your shotgun. Avoid military surplus or hot loaded ammo. The use of reloaded, high pressure or hand loaded ammunition will void the warranty.

NOTICE

SHOTGUNS ARE CLASSIFIED AS FIREARMS OR DANGEROUS WEAPONS and are sold by European American Armory Corporation with the specific understanding that we are not responsible in any manner what-so-ever for their safe handling or resale under local laws and regulations.

European American Armory shall not be responsible in any manner whatsoever for malfunctioning of the firearm, for physical injury or for property damage resulting in whole or in part from (1) intentional or negligent discharge, (2) improper or careless handling, (3) unauthorized modifications and/or alteration to the internal/safety mechanism, (4) defective, improper, high pressure, hand-loaded, or reloaded ammunition, (5) corrosion and/or lack of proper maintenance (6) neglect, or (7) other influences beyond our direct and immediate control. This limitation applies regardless of whether liability is asserted on the basis of contract, negligence or strict liability (including any failure to warn). Under no circumstance shall European American Armory Corporation be liable for incidental or consequential damages, such as loss of use of property, commercial loss of earnings or profits.

SAFETY PROCEDURES

1. We recommend that you get competent firearms instruction in safe handling before using this firearm. Please ask your dealer. All guns are extremely dangerous if carelessly handled or used. Remember that the firearm user is the primary "safety" and to depend on any mechanical devices is to be only half safe.

2. This firearm will fire, if a cartridge is in the chamber and the trigger is pulled and the safety is disengaged.

3. DO NOT LOAD THIS SHOTGUN UNTIL YOU UNDERSTAND HOW THIS SHOTGUN OPERATES. KEEP this shotgun unloaded

at all times except when ready to fire and you are sure of your target.

4. ALWAYS carry this shotgun in a case or original box unloaded.

5. NEVER point this shotgun at anything that is not your intended target even if this shotgun is unloaded. When loading, cleaning, unloading or handling, always be sure the muzzle is pointed in a safe direction and always keep your finger off the trigger.

6. NEVER assume any gun is unloaded. Before handling, check to make sure the chamber is empty. See unloading Instructions and then unload any ammunition. Make sure you know that this or any firearm is fully unloaded before displaying or handling it. When handling any firearm, keep your fingers away from the trigger at all times until you intend to fire.

7. **WARNING:** The actual firearm does not contain any lead; however, it does fire ammunition containing lead or lead compounds known to the State of California to cause cancer, birth defects, reproductive toxicity, and other serious physical injury. Those who discharge a firearm, stand near someone who discharges a firearm or cleans firearms are hereby warned of the dangers presented by lead and lead compounds and should take protective health measures. Avoid exposure to lead while handling and wash your hands after contact. Proper air ventilation is absolutely necessary when shooting indoors.

AMMUNITION WARNING

Old, Hot-loaded and/or reloaded ammunition may be dangerous. Because of the poor or nonexistent quality control standards among some companies or people who make reloaded ammunition

and the dangers of overloads and under loads (squib loads) which may occur, we recommend that only good quality new factory ammunition be fired in our firearms. [If you prepare your own hand loads, do NOT exceed recommended pressures in line with those generated by standard factory loads as manufactured by Remington, Winchester, Federal, PMC or other reputable companies.] Old ammunition may not fire with sufficient force to expel the projectile from the barrel.

READING THESE SAFETY RULES WILL SAVE YOUR LIFE OR THE LIFE OF SOMEONE ELSE

Get instructions from a competent firearms instructor before using this or any firearm. Learn from a professional how to handle, load, unload, operate, fire and care for your gun.

NEVER PLAY with your firearm. It is not a toy and can be a very dangerous weapon that can cause serious personnel injury or death.

Always keep the gun pointed in a safe direction. Treat every gun as if it is loaded... all the time. NEVER point any firearm (loaded or unloaded) at any person or anything you do not intend to shoot. Always keep your gun unloaded until ready to use and make sure that it is unloaded before cleaning.

Keep your finger OFF the trigger until you are actually aiming at the target and ready to shoot. Learn to rest your finger outside of the trigger guard.

Never rely on a gun's "safety" to protect you from unsafe gun handling. A safety is only a mechanical device, not a substitute for common sense and gun safety procedures.

Never leave a gun unattended or where it could fall and fire.

Store guns and ammunition separately beyond the reach of children. Make sure that they are properly secured so untrained individuals and children will be denied access to your guns and ammo.

Test your gun's operation and safeties only at a shooting range while the firearm is pointed in a safe direction.

Know your target and what is beyond. Ask yourself what your bullet will hit if it misses the target or passes through the intended target. Remember, a fired projectile can travel over a mile (including a ricochet) and is capable of going through walls.

Guns and alcohol or drugs do not mix. Don't take any alcoholic beverages and/or drugs before or during shooting activities.

Never pull a gun toward you by the muzzle. Don't climb a tree, cross a ditch or fence with a loaded gun.

Always empty guns before entering a house, car, truck, boat, RV, camp or any building.

When receiving a gun, always open the bolt and check to make sure the chamber is unloaded.

NEVER accept anyone's word that a gun is "unloaded" or "empty". You should immediately open the action and check to make sure it is unloaded.

Be careful with ALL ammunition. Even "blank" cartridges are deadly at close range due to the muzzle blast. Make sure your

ammunition is in new and in good clean condition. Do NOT oil or grease ammo as this may damage the cartridge primer. Do NOT tamper with or alter the standard factory ammunition.

Keep firearms unloaded when not actually in use. Load the gun only when on the range preparing to fire and unload it before leaving the range.

Never put your hand over the muzzle of a gun.

ALWAYS WEAR protective shooting glasses and hearing protection when using firearms.

Spectators should be at least 10 feet behind and away from the shooter while the shooter is loading, shooting and unloading. Spectators should wear protection for hearing and sight loss and they should avoid distracting those shooting their firearms.

Never drop your gun. If you do drop it, unload it and check it for proper function before using it again.

Do NOT alter or modify your gun. Don't try to change your gun's trigger pull, because it may affect sear engagement and thereby cause accidental firing.

Do NOT remove any internal safety or safety device on the firearm. Safety mechanisms are designed to protect you from injury or death.

Do maintain and keep your gun clean. Keep in a dry place away from other metals and water. If your gun shows sign of corrosion or improper operation, have it serviced by a competent gunsmith.

Keep the muzzle pointed in a safe direction when loading and unloading your gun. Never point the muzzle at anyone.

Never shoot at hard flat surfaces or water...bullets ricochet.

If a gun fails to fire when the trigger is pulled, keep it pointed down range at the target for 60 seconds. Sometimes slow primer ignition will cause a "hang fire" and the cartridge will go off after a short pause. If it still fails to fire, keep muzzle pointed in safe direction and avoid exposure to the breech, as you attempt to unload your firearm.

Never let water, snow, mud or other material enter the barrel. Always be sure the barrel is free of any obstruction.

Since many ammunition identifications sound similar, be sure that you use only the correct ammunition for your gun. Do NOT use the wrong size or wrong strength ammunition in your firearm.

Repeated and prolonged exposure to gunfire may cause toxic levels of lead in your body. High levels of lead in the blood may result cancer, impotency, birth defects and other serious physical injury. When shooting indoors, make sure there is proper fresh air ventilation.

Teach Children:

1. NOT to touch guns, bullets, cartridges, shells, flares or any explosive device and.
2. If they discovery such a dangerous item or weapon, they must immediately report its location to their parents, school teacher and police.

Remember a firearm has the capability of taking your life or the life of someone else. Be careful with your firearm - an accident is almost always the result of not following basic safety rules.

HOME SAFETY IS PROBABLY YOUR BIGGEST CONCERN. We suggest a gun lock such as Master Gun Locks. They work on most firearms and are available in gun shops and sporting goods departments. For more information write: Master Gun Locks: Master Lock Company, P.O. Box 10367, Milwaukee, WI 53210. You have invested this much in your new firearm, now invest a little more in your family's safety.

USED FIREARMS - If you got your European American Armory firearm as a used gun, BEFORE USING IT you should unload it and check all its functions to be sure it works correctly. Firearms are some times altered to work incorrectly, or parts may be removed, lost or replaced with incorrect parts. First, unload it and check it yourself and then take it to a good gunsmith who knows European American Armory firearms, and have him examine it.

WRITE US concerning any items or circumstances which you don't understand and which might relate to your safety and the operation of your firearm.

WARNING

BEFORE LOADING or firing a shotgun, examine the bore and the firing chamber to be certain they are clean and free of any obstruction. Even a heavy coat of oil, grease, snow or water may result in damage to the firearm and injury to the shooter and/or persons near the firearm. A misfire or unusual sound upon firing is a signal to cease firing and to examine the chamber and bore. If there is any obstruction, clear the obstruction and clean the bore and chamber before firing.

FIRING WARNING

When shooting, full eye and ear protection is mandatory at all times. Shooters and spectators must wear shooting glasses and sound suppressor to prevent eye injury and hearing loss. Vision loss and hearing impairment can occur with only one moment of non-protection.

WARNING

Any bore obstruction, even if it is only partly blocked, may cause the gun to blow up if it is fired, or may cause damage to the gun such as a bulged barrel. To avoid injury or death to the shooter or bystanders, check the barrel before shooting or if a shot does not sound normal.

WARNING

Always keep the muzzle pointed in a safe direction! Never attempt to load or unload any firearm inside a vehicle, building or other confined space (except a properly constructed shooting range). Enclosed areas frequently offer no completely safe direction in which to point the firearm. If an accidental discharge occurs, there is great risk of injury or property damage. Before loading, always clean all, grease and oil from the bore and chamber, and check to be certain that no obstruction is in the barrel. Any foreign matter in the barrel could result in a bulged or burst barrel or other damage to the firearm and could cause serious injury to shooter or to others.

WARNING

If there is any reason to suspect that a bullet or projectile is obstructing the barrel, immediately unload the firearm (See Unloading Instructions) and check the chamber and the bore.

PARTS LIST

01	Stock	36	Receiver
02	Forend	37	Trigger plate pins (2)
03	Stock retaining screw	38	Shell latch
04	Stock swivel	39	Carrier latch
05	Standart butte plate	40	Latch pins (2)
06	Butt plate screws (2)	41	Carrier latch button
07	Stock washer	42	Shell latch spring
08	Stock connecting rod	43	Latch pin springs (2)
09	Barrel	44	Carrier latch spring
10	Barrel choke	45	Trigger plate
11	Gas piston	46	Carrier
12	Piston plug elastic washer	47	Carrier level
13	Forend cap elastic washer	48	Carrier level pin
14	Magazine spring retaining plug	49	Carrier pins (2)
15	Action bar sleeve	50	Carrier pins springs (2)
16	Action bar and bolt slide	51	Carrier spring guide
17	Sleeve slap spring	52	Carrier spring
18	Bolt slide spring and spring guide	53	Hammer
19	Action bar	54	Hammer pin
20	Recoil spring	55	Hammer spring
21	Breech bolt	56	Hammer spring guide
22	Locking block	57	Trigger
23	Firing pin	58	Trigger pin
24	Firing pin spring	59	Trigger spring
25	Firing pin stop	60	Sear
26	Extractor	61	Sear spring guide
27	Extractor spring guide	62	Sear spring
28	Extractor spring	63	Safety
29	Extractor retaining pin	64	Safety spring
30	Bolt cocking handle	65	Safety spring retaining pin
31	Magazine tube	66	Safety spring guide
32	Forend cap with swivel	67	Choke, full, I
33	Magazine spring	68	Choke, 3/4, II
34	Magazine follower	69	Choke, 1/2, III
35	Magazine spring retaining plug	70	Choke key

A bullet may be lodged some distance down the barrel where it can not easily be seen. Check the bore by using a cleaning rod to pass through the barrel. If a blockage is in the bore, DO NOT ATTEMPT TO SHOOT IT OUT WITH ANOTHER CARTRIDGE, OR BLOW IT OUT WITH A BLANK CARTRIDGE OR A CARTRIDGE FROM WHICH THE BULLET HAS BEEN REMOVED. SUCH TECHNIQUES CAN GENERATE EXCESSIVE PRESSURE, DAMAGE THE FIREARM AND CAUSE SERIOUS PERSONAL INJURY. If the blockage can be removed with a cleaning rod, clean any unburned powder grains from the bore, chambers & mechanism before resuming shooting. If the blockage can not be dislodged by tapping it with a cleaning rod, take the firearm to a gunsmith.

WARNING (Mechanical Malfunctions)

STOP SHOOTING IMMEDIATELY AND UNLOAD YOUR FIREARM if firearm develops; a mechanical malfunction; binding or stoppage; spitting powder/gas; a cartridge primer is punctured; a cartridge case is bulged or ruptured; or the sound on firing does not sound quite right. Do NOT try one more shot but unload your firearm and take it and the ammunition to a qualified gunsmith or send it back to EAA for examination. Do not assume that the shotgun is empty merely because you checked the chamber. You must also check the bore for any fired shot or wad jammed inside the barrel.

EXTERNAL CONTROL PARTS :

Cross Trigger Block Safety : Located on trigger housing behind trigger, push button style. When red ring is exposed shotgun will fire if trigger is pulled!! Do not disengage safety unless you are ready to fire shotgun. (Safety Engaged - The red ring is not showing and the trigger is blocked from full travel; Safety Disengaged - The red ring is showing and the trigger has full travel!... MAKE SURE YOU

UNDERSTAND HOW THE SAFETY WORKS BEFORE YOU LOAD OR USE THE SHOTGUN)

Carrier Latch Button : Located on left hand side of shotgun, protrudes out of forward lower left hand side of the receiver. Pushing in the button will release the carrier latch.

Carrier Latch : Located under the receiver in front of the trigger guard. Depressing the carrier latch button will release the lock on the latch so that it can be moved for loading.

Trigger : Located in the trigger guard with safety disengaged and trigger pulled to the rear, shotgun will discharge.

Bolt Cocking Handle : Located on right hand side of shotgun protrudes from bolt used for pulling the bolt rearward.

Forend Cap : Located on end of magazine tube at the front of the forend and under the barrel. Screws onto magazine tube right hand thread.

DIRECTION FOR ASSEMBLY

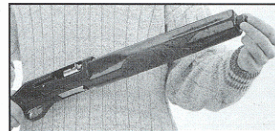
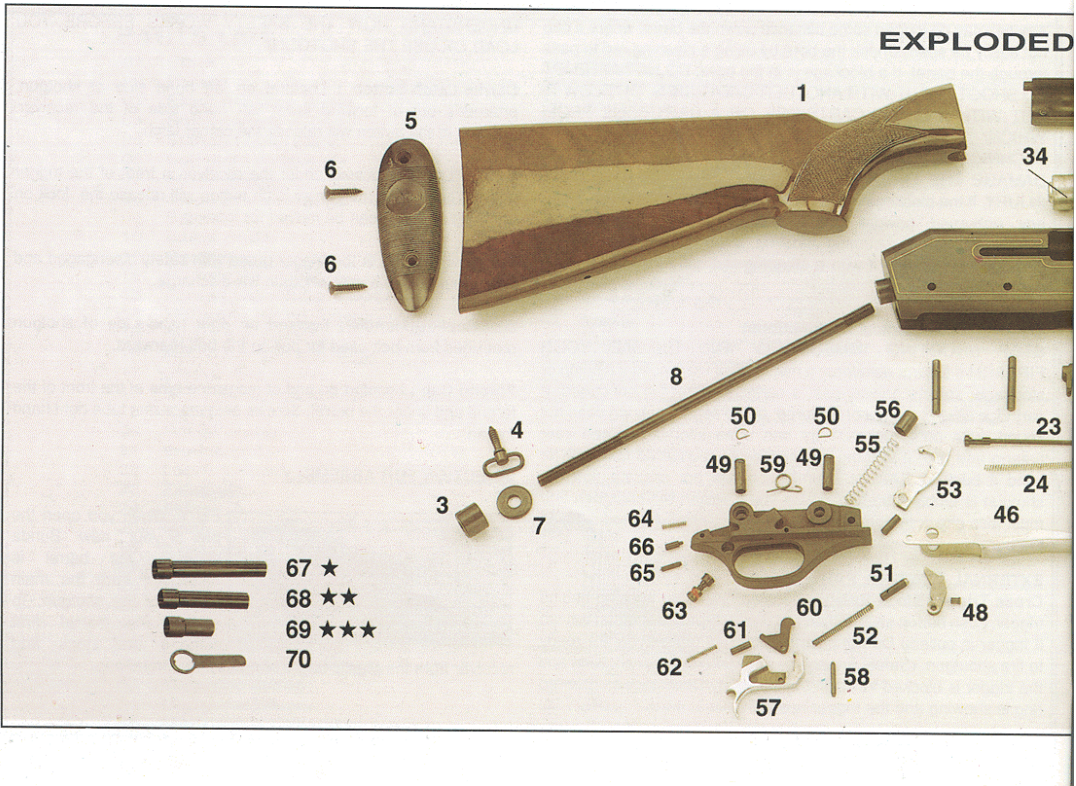
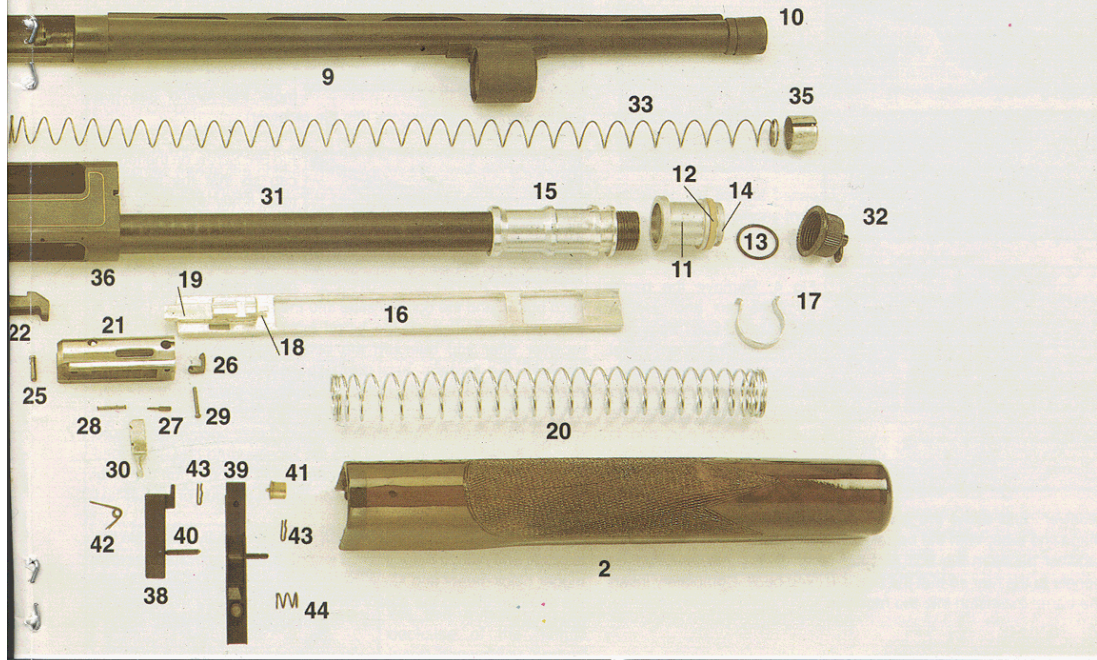

Fig 1: When you open the box of your new Bunda shotgun the barrel is separated from the main portion of the shotgun. To attach the barrel first remove the stock and receiver from the plastic bag. Then unscrew forend cap.



8

VIEW DRAWING



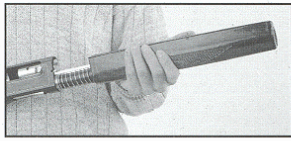

Fig 2: Remove forend from magazine tube.

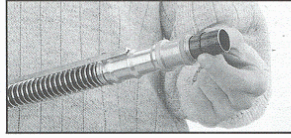

Fig 3: Verify that rubber "O" ring is in place and in good condition

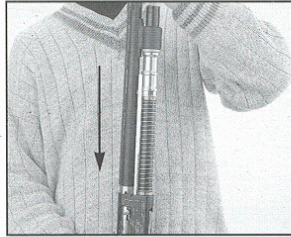

Fig 4: Remove the barrel from the box and remove the plastic bag from the barrel. Insert the barrel extension into the receiver (between the bolt and the receiver) while making sure the barrel gas port ring is aligned with the magazine tube. Continue sliding the barrel extension into the

receiver and allow the barrel gas port ring to slide over the magazine tube. With the barrel extension partially inserted into the receiver between the bolt and the receiver, pull the bolt cocking handle to the rear so that the bolt is locked back. Completely insert the barrel extension into the receiver.

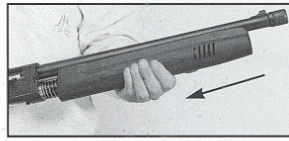

Fig 5: Slide the forend over the magazine tube (do not force). Make sure that the forend is completely seated around the magazine tube, barrel, and the receiver (note the forend has two plastic notches that interlock into the receiver).



Fig 5A: Screw on the forend cap so that the forend is held firmly in place. With the forend in place and the barrel in place and the forend cap securely in place, depress the carrier

latch button and the bolt will slide into the barrel extension (Note: If you see any portion of the barrel extension protruding from the receiver after you released the bolt or if there is a large gap between the forearm and the receiver you have not properly assembled the shotgun). If the bolt does not slide forward or you have gaps or the barrel extension protrudes from the receiver, reverse the assembly procedures and start over again making sure that the barrel is fully inserted into the receiver and that the forend is fully in place. If you still can not assemble the shotgun correctly take the gun to the dealer where you bought the gun or a qualified gunsmith for help.

Once the shotgun is assembled or if you can not fully assemble the shotgun and plan to carry it some where for help, activate the cross trigger block safety and keep it activated until you are ready to fire the shotgun. (Keep the safety on no matter if the gun is loaded or unloaded).

Screw in Chokes Symbols / Markings

The end of the chokes are marked with slashes to determine choke

- / - Full
- // - Improved Modified
- /// - Modified
- //// - Improved Cylinder
- Cl - Clinder

Make sure that you fully install the choke tube before you fire the shotgun. The chokes are right hand thread. Make sure that you do not cross thread the chokes and after use remove the choke tube and clean the choke tube threads and location in the barrel where the choke tube thread into.

DIRECTION FOR DISASSEMBLY

Make sure the gun is unloaded and pointed in a safe direction. Make sure the safety is on. There is no excuse for not being careful.

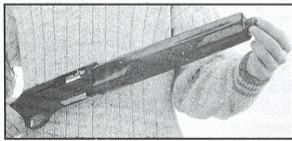

Fig 15: With the bolt in the forward position unscrew the forend cap and remove the forend. Grasp the barrel and remove the barrel by pulling the barrel and barrel extension out of the receiver.

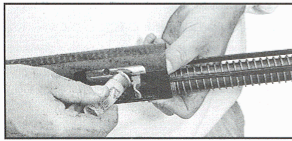

Fig 16: Use the back end of a empty cartridge or a flat-head screwdriver to remove Bolt Cocking Handle. You will see a notch on the backside of the handle. Insert screwdriver or back

of empty cartridge into notch and pry up handle and remove from bolt.

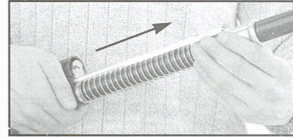

Fig 17: With the cocking handle removed from the bolt you now can grasp the piston and slide the bolt and action bar forward and remove the assembly from the magazine tube and receiver. Be careful because once the bolt is removed from the receiver all the pieces from the assembly are free to separate. We suggest you keep the gun with the bolt up when you remove the assembly so the assembly does not separate.

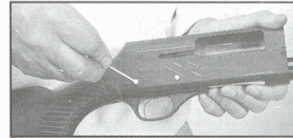
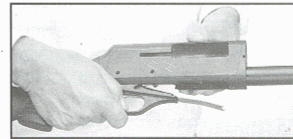

Fig 18 and Fig 19 : The trigger assembly can be removed with the barrel and bolt removed or without the barrel and bolt removed. To remove the trigger assembly all you do is remove the two pins that hold the trigger assembly in place and pull the trigger assembly from the receiver. The pins can be removed with a hammer and a punch.



TO LOAD YOUR SHOTGUN

- * Make sure the shotgun is pointed in a safe direction at all times, the safety is engaged, and never allow fingers or objects to contact trigger.
- * Do not load shotgun until you are ready to fire.
- * Do not disengage the safety until you are ready to fire.
- * Make sure the ammo that you are using is the correct size and gauge. The barrel is marked with the gauge and chamber size, barrels marked 3" will also use 2 3/4" or 3" shot shells.
- * Visually inspect the chamber for obstructions by pulling back the bolt until it locks back. The chamber should be free of oil or grease or obstructions... The chamber is the rear portion of the barrel where the cartridge slides into from the pressure applied by the bolt. After inspection release the bolt by depressing the carrier latch button.



Fig 7: Turn the shotgun upside down so that the barrel is pointing toward the ground and you are looking at the carrier latch. Now depress the carrier latch button and insert up to (5) - 2 3/4" cartridges or (4) - 3" cartridges in to the magazine tube.

****WARNING****

Never load a cartridge into the chamber until you are ready to fire the shotgun...

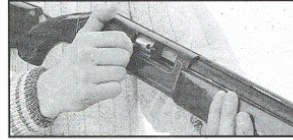

Fig 8: Turn the gun upright with the barrel pointing to the ground and pull back the bolt cocking handle till a cartridge moves up into the ejection port. Now release the handle and the cartridge will be carried by the bolt into the chamber.

TO FIRE YOUR SHOTGUN

WARNING

- * During firing, the bolt cocking handle travels reward with considerable force and velocity. Do not allow any object to enter its' path.
- * Do not disengage the safety until the shotgun is pointed in a safe direction and you are ready to fire.
- * Semiauto shotguns automatically feed the next live round from the magazine tube into the chamber each time the gun fires. No mechanical force is required for the shotgun to complete there-chambering operation, thus you must be aware that the firearm will be ready to fire another round after the previous round has been ejected and the new round has been chambered.
- * After the last round has been fired the shotgun should lock open, never count on the locked back bolt as a signal that the gun is empty, it is possible that the bolt will not lock back after the firing of the last cartridge. If this occurs, open the bolt manually and lock it to the rear... Use your eyes to verify that the gun is empty.

* If a cartridge does not fire and the trigger has been pulled and the safety is disengaged... Stop! and do the following:

a) Make sure the gun is pointed in a safe direction b) Engage the safety c) Wait 60 seconds d) Follow the instruction below for unloading the shotgun.

* If during firing the sound of any cartridge is noticeably softer or louder than the previous cartridge fired. Stop! Do not load another cartridge or fire another cartridge and do the following:

a) Make sure the gun is pointed in a safe direction b) Engage the safety c) Follow the instruction below for unloading the shotgun d) With the shotgun unloaded visually inspect the shotgun for barrel blockage or damage and inspect the mechanical portion and receiver of the shotgun for damage before continuing.

*** PLEASE READ AND UNDERSTAND ALL WARNINGS IN THIS MANUAL BEFORE FIRING SHOTGUN, MAKE SURE YOU KNOW WHAT YOU ARE SHOOTING AT**

- 1) Make sure the gun is pointed in a safe direction and that you are wearing ear and eye protection.
- 2) Engage safety if not already engaged
- 3) Disengage the safety and begin firing only when you are ready to fire and the shotgun is pointed in a safe direction to be fired.

TO UNLOAD SHOTGUN

1) Make sure that gun is pointed in safe direction and engage safety, if not already engaged. Never allow your finger or any object to come in contact with the trigger during the unloading operation...

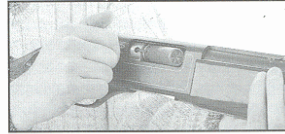

Fig 9: Draw back the bolt until a cartridge is ejected or the bolt has traveled to the rear fully (if there was not a cartridge in the chamber nothing will be ejected) slide the bolt

forward until it is fully closed. Now draw back the bolt until a cartridge is ejected. Repeat the drawing back of the bolt until no more rounds are ejected and the bolt is locked in the rearward position... now visually inspect the chamber to assure that it is empty, you should also look down into the receiver through the ejection port and verify that the magazine tube is empty. If for some reason the cartridge in the magazine tube will not rise up into the chamber after repeated attempts to manually cycle the shotgun, perform the follow the following steps:

A) Manually close the bolt

B) Turn over the shotgun so that the trigger guard is facing you (upward), depress the carrier latch button and then depress the carrier latch.

C) With the same finger that you are depressing the carrier latch depress the shell stop (the shell stop is located on your left hand side with the gun in the upside down position, it is the piece of metal that should be holding the cartridge in the magazine tube) and the cartridge should slide up and out of the shotgun with your guidance.

Note: the cartridge is under spring tension. Repeat this process until the magazine tube is empty and then turn the gun over and lock the bolt back and verify that the gun is totally empty. If you had to follow the procedure for a cartridge not being released from the magazine tube, make sure the gun is empty and let a qualified gunsmith inspect the gun before you load or use the gun again.

MANUFACTURER'S WARNING

This firearm was manufactured to properly perform with the original parts as designed. It is your duty to make sure any parts you buy are correctly installed and that neither replacements nor originals are altered or changed. Your gun is a complex tool with many parts that must relate correctly to other parts for safe and accurate operation. Putting a gun together wrong or with modified parts can result in a damaged gun, injury or death to you or others through malfunction. Always let a qualified gunsmith work on your gun or at least, check any work not performed by a gunsmith. Firearms safety is your primary concern. **THE GUN OWNER MUST ACCEPT FULL RESPONSIBILITY FOR THE CORRECT REASSEMBLY AND FUNCTIONING OF THE FIREARM AFTER ANY DISASSEMBLY OR REPLACEMENT OF PARTS.**

CLEANING AND MAINTENANCE OF SHOTGUN

- A) Follows procedures for unloading shotgun as described previously
- B) Follows procedures for disassembly of shotgun as described previously

- 1. Materials needed to clean this shotgun are: a cleaning rod, cotton bore patches, brass bore brush, powder solvent, a small soft brush and good quality gun oil.

WARNING: Lead or lead compounds are known to the State of California to cause cancer, birth defects, reproductive toxicity, and other serious physical injury. Those who clean firearms should take protective measures to avoid contact or exposure to such chemicals.

- 2. Using the bore brush with powder solvent scrub the barrel and chamber to remove any powder and lead residue in the bore. Always and lastly, swab with cotton patch with gun oil to coat and protect the bore and chambers from rust and corrosion.

- 3. Any powder fowling on the firing wall, barrel, etc, can be easily cleaned with a brush and powder solvent.

- 5. All external surfaces should be wiped down with light coat of rust preventative. Avoid using too much oil as dust and/or debris can get trapped in the oil creating a gum that in time will cause misfires.

- 6. CAUTION in using solvents in gun bore cleaning. Prolonged and excess contact with finish or bluing can damage the gun's finish. Be sure to wipe away all excess solvent and then lubricate with oil.

- 7. A gun should be cleaned after firing. In addition, external parts should be wiped with an oiled cloth after handling. A light oil is ordinarily all that is necessary in cleaning, if the gun has not been fired or fired very little. If a gun is used frequently, it must be cleaned after each firing and regularly serviced by a professional gunsmith. If the gun has been stored, remove all excess oil and/or grease before firing. Always check to be sure that no cleaning patch or other obstruction remains in the bore or chambers before firing.

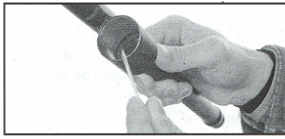

Fig 13: The two holes in the barrel gas porting ring which must remain open and clear for the shotgun to function properly. Make sure these two holes are cleaned after each use as

well as clean the barrel gas porting ring.

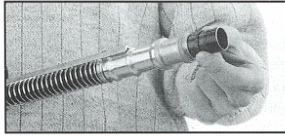

Fig 14: The gas piston assembly on the magazine tube. These parts must be cleaned and lightly oiled after each use. Inspect the rubber "O" ring after each use for cracks and splits,

etc, replace "O" ring if it is not in good condition.

DANGER -- AMMUNITION WARNING

Firearms may be damaged and serious injury or death to the shooter or bystander may result from any condition which contributes to the generation of excessive pressure or uncontrolled release of gas within the firearm. Such adverse conditions can be caused by bore or chamber obstruction, properllant powder overloads or by defective, incorrect or improperly loaded and assembled cartridge components. Even the strongest firearm can be blow up as a result of excessive pressure. It is extremely dangerous to use a cartridge whose presure is greater than that developed by cartridges loaded to industry standards.

AMMUNITION (CARTRIDGES) NOTICE

We specifically disclaim responsibility for any damage, injury or death occurring in connection with or as the result of the use of European American Armory shotguns of faulty, non-standard, remanufactured, hand loaded or reloaded ammunition, used cartridges or cartridges other than factory cartridges for which the firearm was originally chambered.

LUBRICATION WARNING

Firing a shotgun with oil, grease or any other material even partially obstructing the bore may result in damage to the shotgun and injury to the shooter and those nearby. Do not spray or apply lubricants directly on ammunition. If the powder charge of a cartridge is affected by the lubricant, it may not be ignited, but the energy from the primer may be sufficient to push the bullet into the bore where it may become logded. Firing a subsequent bullet into the obstructed bore will damage the shotgun and may cause injury to the shooter and those nearby. Use lubricants properly. You are responsible for the proper care and maintenance of your firearm and ammunition.

LIFE TIME LIMITED WARRANTY

All European American Armory Corp. firearms are warranted to the original retail customer for life from date of purchase against defects in material and workmanship. All parts and labor or replacement at our option are covered. (Rubber gas "O" ring is warranted for 30 days from purchase... Wood Stock and Wood Forend are not covered by the Limited Lifetime Warranty. The warranty on the wood stock and forend is 60 days from purchase and only covers manufactured and material defects.) Transportation to and from our repair facilities, damage caused by failure to perform normal maintenance, sales outside the United States, damage due to use of high velocity, high pressure, reloaded

or other nonstandard ammunition, or any unauthorized repair, modification, misuse, abuse, or alteration of the product is not covered by this Limited Warranty.

Any implied warranties, including the implied warranties of merchantability and fitness for a particular purpose, are limited to one year from date of original retail purchase. Consequential or incidental damages and/or expenses, or any other expenses are not covered by this warranty.

To obtain warranty performance send your firearm with proof of retail purchase, freight prepaid to:

European American Armory Corp.
3855 North U.S. Highway One
Cocoa, Florida 32927

WARNING

Altering or modifying parts and/or internal safeties is dangerous and will void the warranty. This shotgun was manufactured to perform properly with the original parts as designed. It is your duty to make sure any parts you buy are made for this firearm and are installed correctly and that neither the replacement nor originals are altered or changed. Your gun is a complex precision tool with many parts that must relate correctly to other parts in order for proper and safe operation. Putting a gun together wrong or with incorrect or modified parts can result in a damaged gun, danger, and injury or death to you and others through malfunction. Always have a qualified gunsmith work on your gun or at least check any work not performed by a gunsmith.

YOUR OWNERS' MANUAL

Always keep this manual with your firearm. Make sure you understand all the warnings, operation instructions and safety procedures. When you lend, give or sell the firearm, be sure this manual goes with it. You can get a copy of this manual from European American Armory on request.

ALL PARTS ORDERS ARE SUBJECT TO A \$ 10.00 CHARGE FOR SHIPPING AND HANDLING.

Please state Model, Caliber, Serial Number, and Finish Color when ordering. For parts, information and service contact: European American Armory Corp., 3855 North U.S. Highway One, Cocoa, Florida 32927 Phone: (407) 639-4842.

MANUFACTURER :

ŞERİTSAN / ÜÇLER AV / TÜRKİYE

IMPORTER :

EAA / COCOA, FL